

Date: June 5, 2018

ECRN 2018-0392

Rev A

Priority Status:

	P1: Needs completed at your earliest opportunity
	P2: Needs completed at the next service
X	P3: Product improvement completed as needed
	P4: Instructions only

Read and fully understand this Technical Communications Bulletin before beginning. Follow instructions completely. If you should have any questions or concerns regarding this Technical Communications Bulletin, please contact your regional Snorkel Product Support Department.

This procedure applies to all machines with an enable switch operated joystick. The purpose of this bulletin is to install a joystick trigger guard. To determine the correct Snorkel kit for your joystick please see the options shown in the figures below. These kits can be ordered by contacting the Snorkel Parts Department.

This procedure is a **Product Improvement Only**. All parts and labor will be at the customer expense.

This procedure will take approximately 30 minutes to perform.

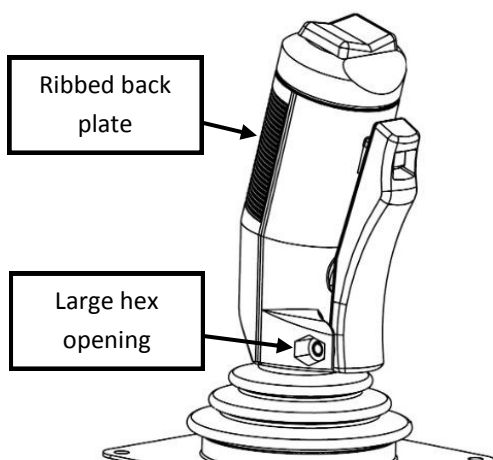

Snorkel kit needed: 3028934

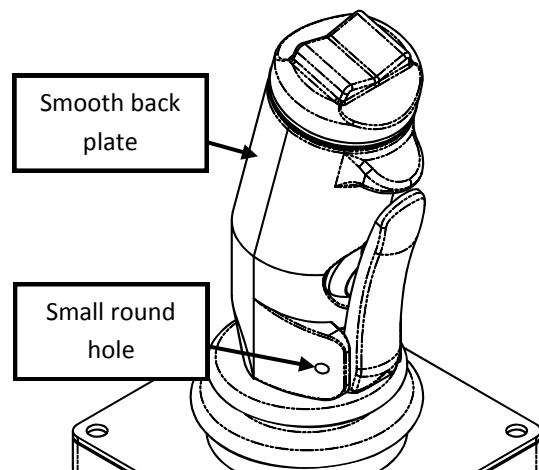

Snorkel kit needed: 3028935

Tools Required: Phillip's screwdriver, standard screwdriver, Torx driver, soldering kit, needle nose pliers

⚠ Warning

Always follow safe working practices and use appropriate personal protection equipment when performing any procedures within this bulletin.

To install 3028934 Guard Kit, see the following steps.

1. Position the two halves, one on each side of the joystick.
2. Wedge the lip of the guard under the top boot for a snug fit.
3. Fit the hex key into the hex hole on each side of the joystick.
4. Install the 4-20 x 5/8in Torx screws, tighten using a Torx driver. **Note: Do not overtighten as damage may occur.**

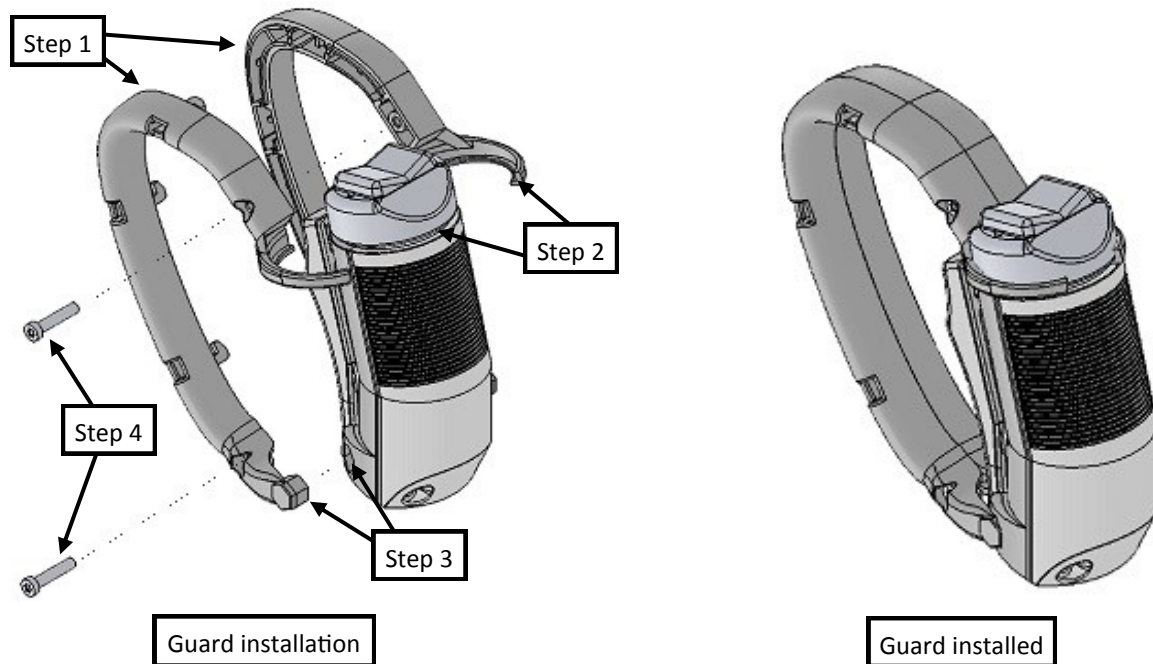

To install 3028935 Guard Kit, see the following steps.

1. Use a small standard screwdriver to gently pry the split ring from the rubber steer switch cap (see figure 1).
2. Remove the rubber steer switch cap (see figure 2).
3. Using a standard screwdriver remove the screw securing the trigger to the joystick (see figure 3). Set screw and trigger aside.
4. Using a Phillips screw driver remove all four screws from the joystick (see figure 4).



Figure 1



Figure 2



Figure 3

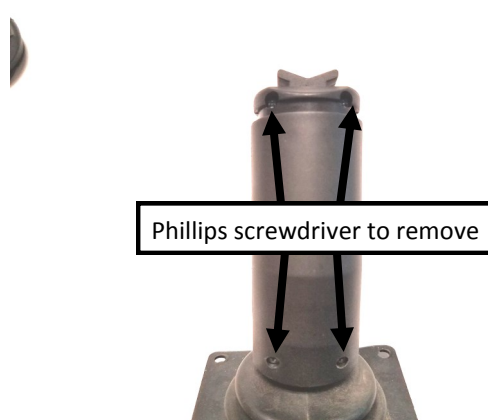

Figure 4

5. Gently pull the back off the joystick. A standard screwdriver may be used to pry the sections apart (see figure 5).
6. Carefully remove the steer rocker and the micro-switch from the joystick (see figure 6).
7. Using a soldering iron, remove both wires from the enable switch (see figure 7). **Note: Over heating the terminals may cause damage to the wires and/or the switch.**
8. Using needle nose pliers, remove the jamb nut and remove the enable switch from the joystick (see figure 7-8).



Figure 5

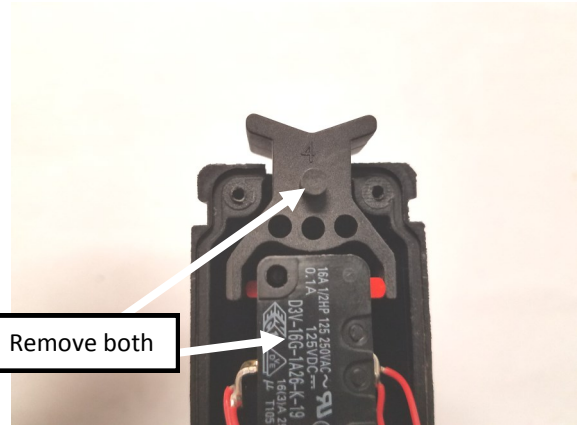

Figure 6

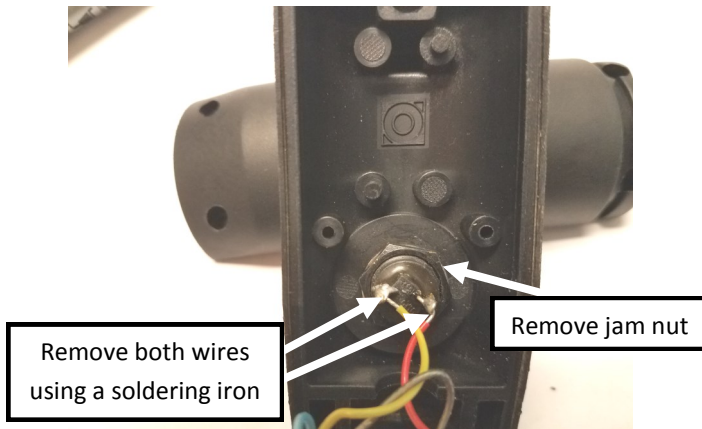

Figure 7

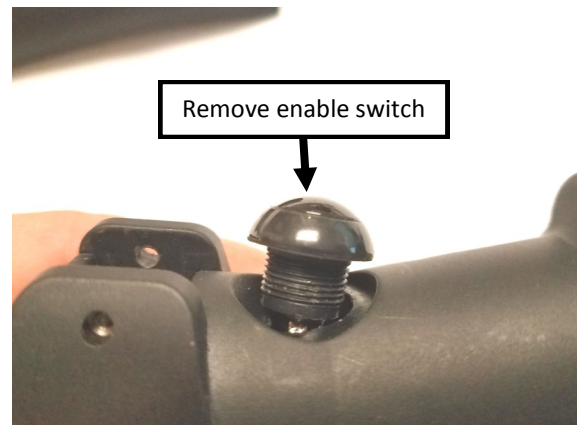

Figure 8

9. Install the enable switch into the front cover supplied in kit, tighten the jam nut until secure (see figure 9).
10. Following normal soldering procedures, attach both wires onto the enable switch (see figure 9).
11. Position the micro-switch into the joystick so that the blue wire is facing up (see figure 10).
12. Install the steer rocker (see figure 10).
13. Slide the front half of the joystick cover into place as per (figure 11). **Note: The front half will install on the slant side.**
14. Install the back half and tighten the hardware until secure (see figure 12).
15. Install the trigger and tighten the screw until secure (see figure 12).
16. Install the steer rocker cover and secure with the split ring (see figure 12).
17. Position the trigger guard supplied in kit onto the joystick. Snap the bottom mounting holes into the recessed area on each side of the joystick (see figure 12).
18. Install the four screws supplied with kit and tighten until secure (see figure 12).

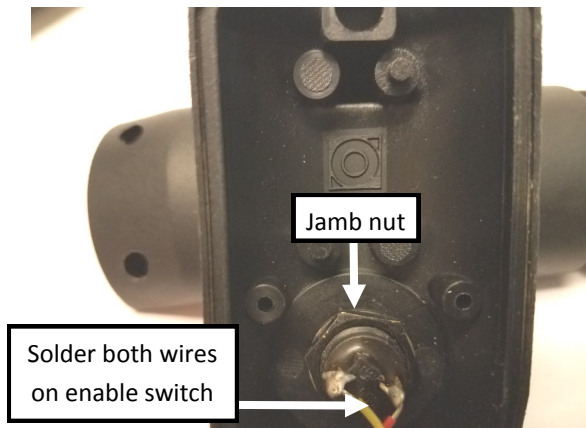

Figure 9

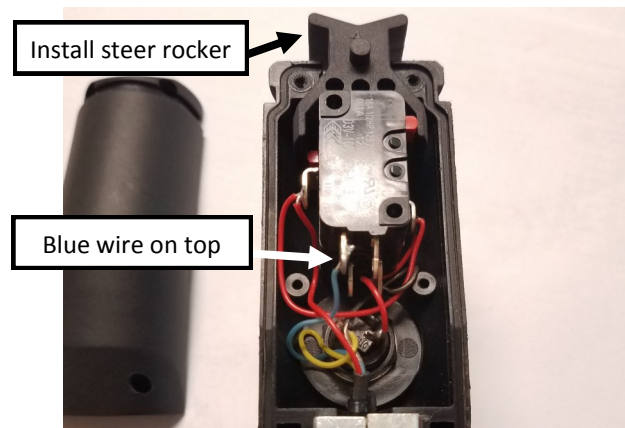

Figure 10

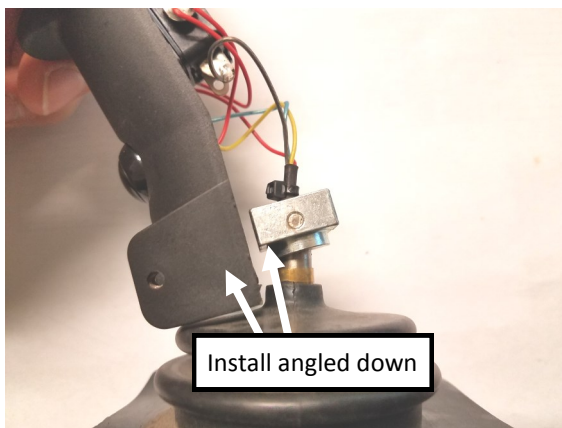

Figure 11

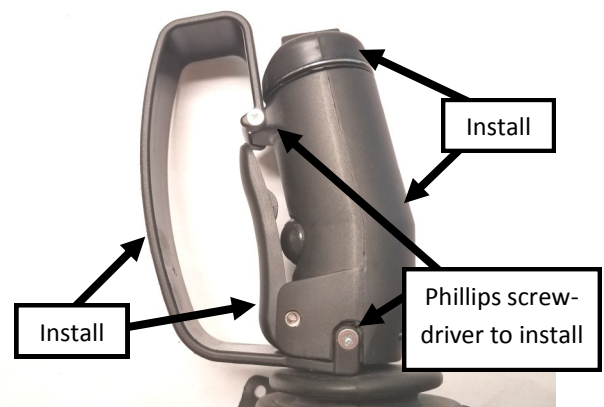

Figure 12



For Further Information in North and South America

Contact the Snorkel Service Department at:

Phone: 1-800-255-0317 or 1-785-989-3091

Fax: 1-785-989-3075

Or contact the Snorkel Service Department via email at:

Tony.deatherage@snorkellifts.com

jerry.simmons@snorkellifts.com

tom.george@snorkellifts.com

allan.kelly@snorkellifts.com

chuck.adkins@snorkellifts.com

mike.koon@snorkellifts.com

Sam.deck@snorkellifts.com

mike.sharp@snorkellifts.com

bob.lowry@snorkellifts.com

ceasar.valdez@snorkellifts.com

Further Information in EMEA

Contact the Snorkel Service Department at:

Phone: +44 (0) 191 4616909 / +44 (0) 191 4616910

Or contact Technical Support via email at:

mark.hutchinson@snorkellifts.com

brian.aitchison@snorkellifts.com

neil.brown@snorkellifts.com

kevin.handley@snorkellifts.com

For Further Information in Australia

Contact the Snorkel Service Department at:

Phone: 1300 700 450

Or contact Technical Support via email at:

bruce.maclean@ahernaustralia.com.au

david.wynne@ahernaustralia.com.au

For Further Information in Asia Pacific

Contact the Snorkel Service Department at:

Phone: 03-5765-6841

Or contact Technical Support via email at:

Fun Fook Wai : fw.fun@snorkellifts.com

For further Information in Asia (Japan)

Contact the Snorkel Service Department at:

Phone: 03-5765-6841

Or contact Technical Support via email at:

sakuma@snorkeljp.com